

*Power It* LVMDP (Low Voltage Main Distribution Panel) – PiPS-Distribution Series



### Product Information

*Power It* Power Enclosure are used in industrial and commercial applications, whether for low voltage. They are composed of switching equipment, including switches, fuses, circuit breakers, control panels, isolators, transformers, relays, and other associated tools.

*Power It* Power Enclosure are working together to securely distribute power in an electrical system while also protecting the whole electrical device in case of possible faults or overloads.

### Features

- Short circuit performance able to achieve up to 100kA for 1 second.
- Use of insulated copper busbars with a minimum purity of 99.90; prevents risk of short-circuit (Compliant to IEC 61439)
- Up to Form 3b form of internal separation.
- Ingress Protection up to IP66 (Compliant to IEC 60529)
- Compact and flexible modular design conserves maximum space
- Customisable to special dimensions according to customer requirements.
- Compliant to IEC standards 61439-1, -2; designed to meet local technical standards, practices and requirements.
- High forming of frame structure enclosures greater mechanical strength and toughness.

- The frame body requires a welding process for strength and rigid construction, the interior and cover are connected with bolts and nuts, making it easier to disassemble and assemble..
- used naturally ventilated, option to insert additional fans for greater heat dissipation.
- Fully quality internal inspection and quality assurance before delivery.

### Technical Specifications

Specifications	ACB Type			MCCB Type			PDU-Panel
	Below 4000A	4000A	Above 5000A	Below 250A	400A ~ 1600A		
Part Number	PIPS200204	PIPS200404	PIPS200604	PIPS100200	PIPS080100	PIPS200202	PIPS200101
Height (mm) w/o Plint (100)	2000			1000	800	2000	2000
Width (mm)	800	1000	1200	800	600	800	600
Depth (mm)	1000	1200		250	250	800	600
Material	Premium grade Cold rolled steel sheet (Spcc), High grade Galvanized / Galvalum / Stainless Steel						
Thickness	1.5 ~ 2 mm						
weight (Empty - approx)	300 Kg	350 Kg	400 Kg	85 Kg	55 Kg	275 Kg	200 Kg
Pretreatment Process	Five stage iron-phosphate pretreatment, tested to 480 hours salt spray According to ASTM B117; ASTM D 1654						
Painting of all parts	Powder coated (Ral-7032/Dark grey; Ral-7035/Light grey); Standart zones C3M up to C5M, conforming ISO 12944-6						
IP degree of protection	Indoor :IP43; Outdoor: up to IP66, conforming IEC 60529						
IK degree of protection	IK10 conforming IEC 62262						
Cable Entry	Top and Bottom ( Removable top & bottom panel)						
Door sealing	Polyurethane Gasket Foam						
Smart Features	Integrated with the IoT or intelligent monitoring systems						

### Construction Drawing

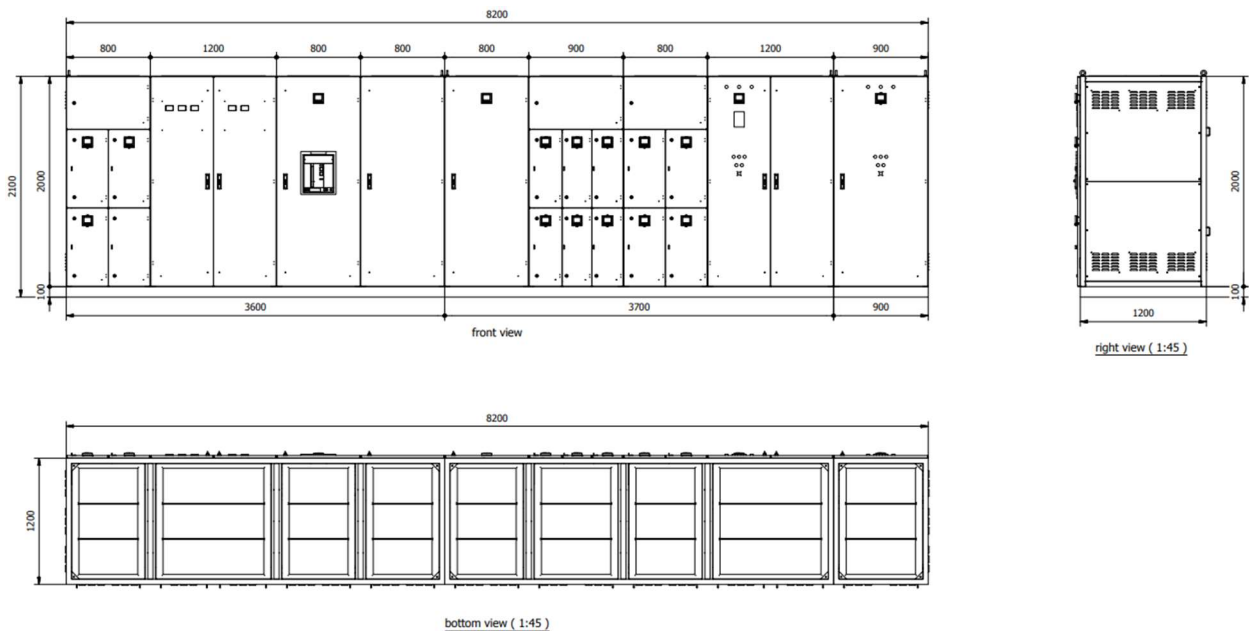

### Exploded View ( Cell 2 )

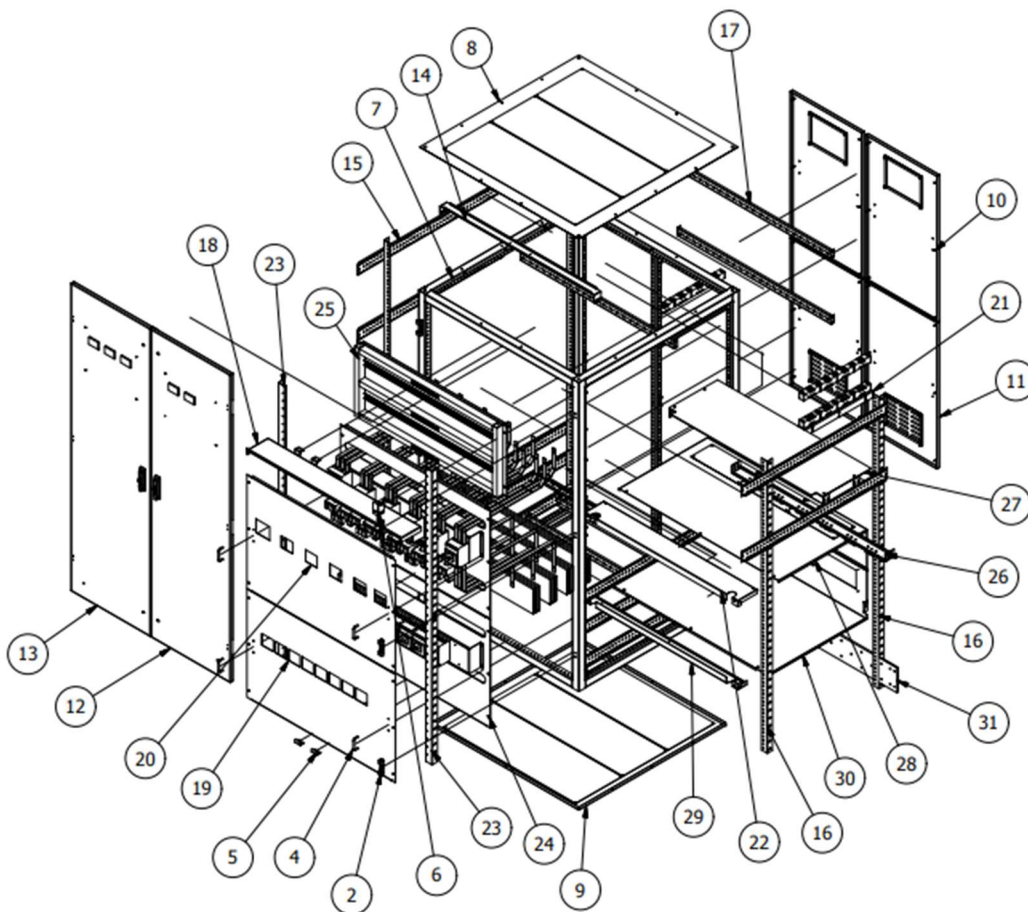

PART LIST				
2	Engsel Tekuk	203020044; QL08A; HINGE CONCEALED STEEL (ENGSEL GAL-GAL)	6	Generic
3	Mur Tembak FHSM M6 x 13.5	304010024; MUR TEMBAK M6 TYPE HSM	48	Steel, Mild
4	Handle U75		4	Generic 0.5 mm
5	Stopper Root		4	SPCC 2 mm
6	Limit Switch FS D4MC-5000 Bend		1	SPCC 2 mm
7	SW_Rangka_Body w1200		1	
8	SA Top Cover w1200		1	
9	SA Cover Bottom w1200		1	
10	assy cover rear top w1200		2	
11	assy cover rear bottom w1200		2	
12	SA Door Front 2 R		1	
13	SA Door Front 2 L		1	
14	Bracket Lamp TL w1200		1	SPCC 2 mm
15	Punch Section A		10	SPCC 2 mm
16	Frame Mounting		4	SPCC 2 mm
17	Cable Support w1200		6	SPCC 2 mm
18	Sekat Mounting MCB w1200		1	SPCC 2 mm
19	Updeck bawah 2		1	SPCC 1,5 mm
20	Updeck atas 2		1	SPCC 1,5 mm
21	SA Busbar Main w1200		1	
22	Support Cover Incoming Bar.2		1	SPCC 1,5 mm
23	Frame Updeck Flat		2	SPCC 2 mm
24	SA Mounting TR-3 2B		1	
25	SA Mounting TR-3 w1200		1	
26	SA Busbar Support TR-3 2		1	
27	SA Cover Busbar Atas 3-2		1	
28	SA Cover Incoming Busbar 3-2		1	
29	Support Cover Incoming Bar Bawah 3-2		1	SPCC 1,5 mm
30	SA Cover Outgoing Busbar 3-2		1	
31	Busbar Ground TR-3 2		1	Busbar 10x 10 mm

### Construction Drawing (Smart DP)

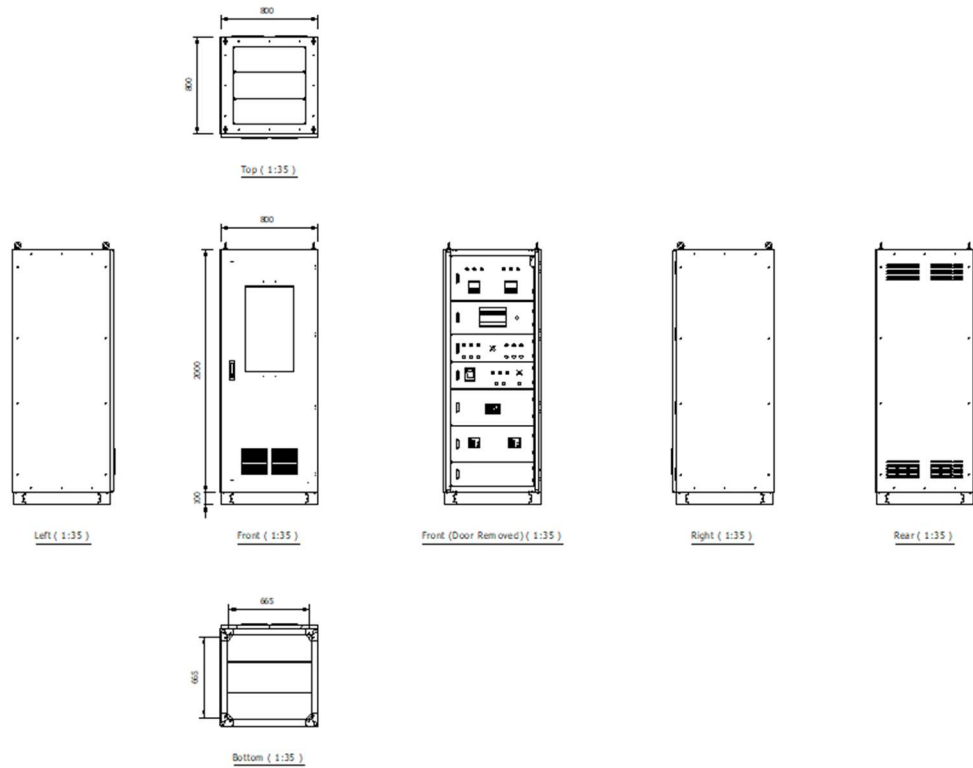

### Exploded View (Smart DP)

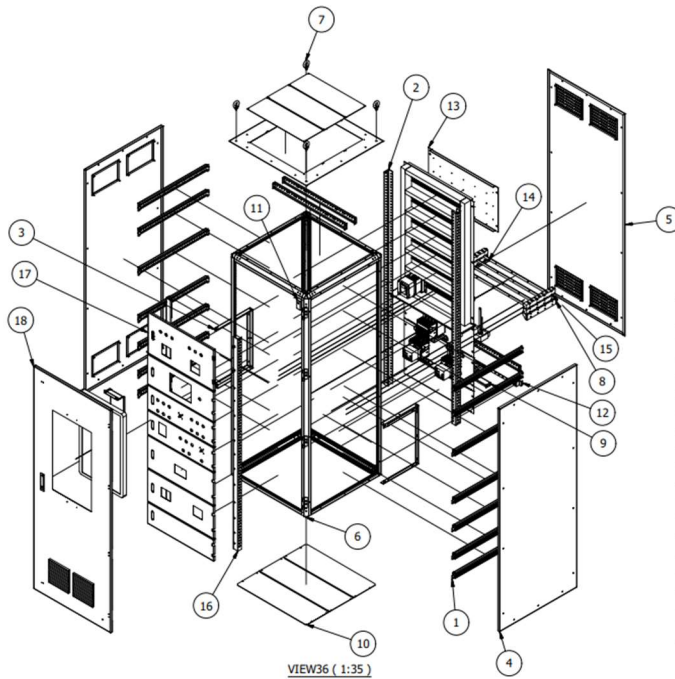

PART LIST			
1	punch section	14	SPCC 2 mm
2	frame mounting	2	SPCC 2 mm
3	frame polycarbonate	2	SPCC 2 mm
4	assy cover samping	2	SPCC 1.5 mm
5	assy cover belakang	1	SPCC 1.5 mm
6	welding rangka	1	SPCC 2 mm
7	assy cover atas	1	SPCC 1.5 mm
8	cable support	3	SPCC 2 mm
9	support isolator XT2	1	SPCC 2 mm
10	assy cover bawah	1	SPCC 1.5 mm
11	ddk limit switch	1	SPCC 2 mm
12	ddk busbar PE	2	SPCC 2 mm
13	assy mounting	1	SPCC 2 mm
14	ddk busbar support EL295	2	SPCC 2 mm
15	assy busbar main	1	SPCC 2 mm
16	assy frame updeck hinge pintu	1	SPCC 2 mm
17	Assy Updeck Pintu	1	SPCC 2 mm
18	assy pintu	1	SPCC 2 mm